

**WORKING POSITION**

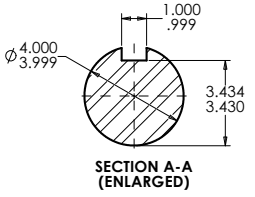

**GEARBOX DATA:**

- INPUT: POWER: **400 HP** SPEED: **1800 RPM.**
- RATIO: **2.53:1** (SPEED REDUCER)
- ROTATION: **ENGINE.**
- LUBRICATION TYPE: **CIRCULATING COOLED OIL.**
- SUMP CAPACITY: **5.0 GALLONS APPR.**
- SURFACE FINISH: PER CUSTOMER REQUEST.
- APPR. WEIGHT: **1,250** lbs W/O OIL.

		<b>RJ Link International, Inc.</b> Rockford, IL 61109, USA		THIRD ANGLE PROJECTION 
<small>This document is the property of RJ Link International, Inc. and is loaned to the recipient for his confidential use only in consideration of the loan of this drawing, recipient promises and agrees that it shall not be used in any way detrimental to the interest of RJ Link International, Inc., that it shall be returned upon request, and it shall not be reproduced, copied, loaned or otherwise disposed of directly or indirectly without the expressed written consent of RJ Link International, Inc.</small>				
<small>TORSIONAL VIBRATIONS EXIST IN ALL ROTATING SYSTEMS. IT IS THE SOLE RESPONSIBILITY OF THE EQUIPMENT MANUFACTURER OR ASSEMBLER TO INSURE THAT NO DAMAGING CRITICALS FALL IN THE OPERATING RANGE OF THE SYSTEM.</small>				
DESCRIPTION <b>REDUCTION GEARBOX</b>		DRAWING NO. <b>D175E250001</b>		
DESIGNED MMM	DATE 9/16/2017	SCALE 1:5	PART NO. D175	SHEET 1 OF 1 00
CHECKED JO	DATE 9/17/2017			
ENG APP JO	DATE 9/17/2017			